

H[®] TECHNICAL BULLETIN

PRIMAAX[®] / FIREMAAX[®] Support Beam Assembly

SUBJECT: Discontinued Support Beam Assemblies

LIT NO: SEU-0229

DATE: April 2010

REVISION: A

IMPORTANT NOTICE

Effective May 1, 2010, support beam assembly part numbers 66435-00X or 60831-00X (Forging Part Nos. 59363-001, 65082-000, and 65284-000) for PRIMAAX[®] • FIREMAAX[®] suspension systems are discontinued for field service purposes for North and Central America, see Figure 1.

FIGURE 1

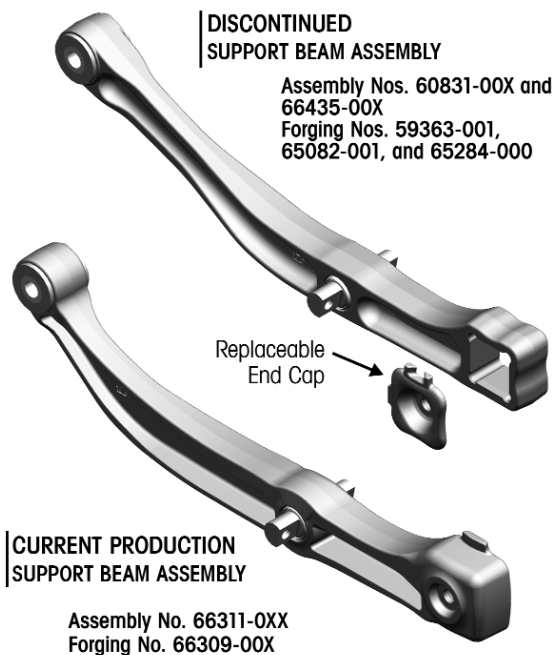

U-beam assembly service kits (part number 60961-XXX, see Figure 2) **must be** used for any necessary replacement of PRIMAAX • FIREMAAX support beam assemblies (part numbers 66435-00X or 60831-00X) in the field. Refer to Table 1 on page 3 to determine the U-beam assembly service kit for each respective vehicle manufacturer.

Follow the PRIMAAX EX • FIREMAAX EX • PRIMAAX • FIREMAAX component replacement procedures and safety instructions in Hendrickson Technical Publication number 17730-238 to install the U-beam assembly service kits. Visit Hendrickson's web-site for the latest version of 17730-238.

FIGURE 2

**U-beam Assembly Service Kit
equipped with current production
support beams**

Part No. 60961-XXX
See Table 1 on page 3

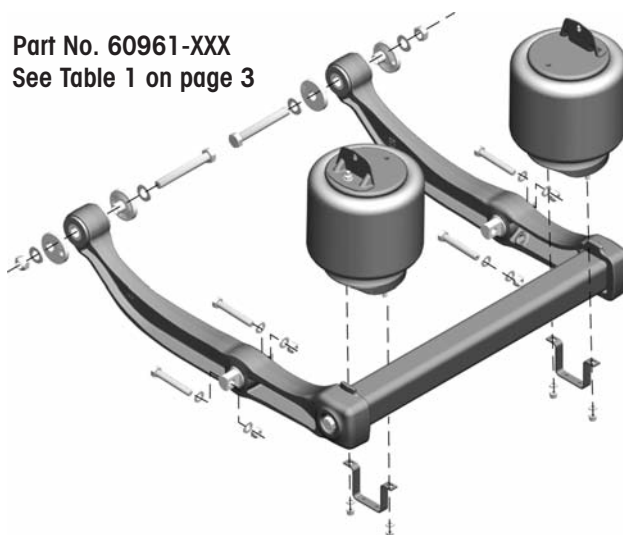



U-BEAM ASSEMBLY SERVICE KIT INSTALLATION

The U-beam assembly service kits (part number 60961-XXX, see Figure 2) are designed for the discontinued support beam assemblies and their related components on one axle and do not require additional drilling or modifications.

WARNING

DO NOT USE A COMBINATION OF A DISCONTINUED (PART NOS. 60831-00X OR 66435-00X) WITH CURRENT PRODUCTION (PART NO. 66311-0XX) SUPPORT BEAM ASSEMBLIES ATTACHED TO THE SAME (AXLE) CROSS TUBE. USE OF DIFFERENT SUPPORT BEAM ASSEMBLIES AND/OR AIR SPRINGS ON THE SAME (AXLE) CROSS TUBE CAN RESULT IN VEHICLE LEAN AND/OR VEHICLE HANDLING PROBLEMS. IT IS ALLOWABLE TO HAVE DIFFERENT U-BEAM ASSEMBLY TYPES ON DIFFERENT AXLES.

U-BEAM ASSEMBLY SERVICE KITS

Support beam assemblies are available for field service purposes in U-beam assembly kits, refer to Table 1 on page 3. Former PRIMAAX • FIREMAAX suspension support beam assemblies must be serviced with these kits.

Each service kit, see Figure 2, is intended for servicing the associated suspension parts on one axle, and includes two new support beam assemblies, one cross tube, two air spring assemblies, air spring hardware, QUIK-ALIGN® hardware and D-pin hardware.

U-beam Assembly Service Kit No. 60961-XXX includes	
DESCRIPTION	Qty.
Support Beam Assembly	2
Cross Tube	1
Air Spring Assembly	2
Air Spring Fasteners	
QUIK-ALIGN Fasteners	
D-Pin Fasteners	

NOTE

The support beam forging number, see Figure 3, can be used to help identify the support beam assembly part numbers and the U-beam assemblies that contain them. Support beam assembly part numbers **are not** shown on the beam.

FIGURE 3

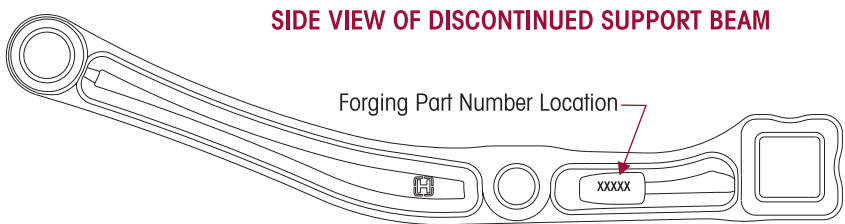

NOTE

The support beam forging numbers can be used to help identify the support beam assembly part numbers and the U-beam assemblies that contain them. Support beam assembly part numbers **are not** shown on the beam.

PRIMAAX 230/460/690 FIREMAAX 240/480				PRIMAAX 260/5200/780 FIREMAAX 270/540			
DISCONTINUED Forging Number 59363-001 65082-000	DISCONTINUED SUPPORT BEAM ASSEMBLIES			DISCONTINUED Forging Number 59363-001 65082-000	DISCONTINUED SUPPORT BEAM ASSEMBLIES		
		LEFT	RIGHT			LEFT	RIGHT
DISCONTINUED Forging Number 65284-000	REAR	60831-001	60831-002	DISCONTINUED Forging Number 65284-000	REAR	60831-005	60831-006
	FRONT	60831-003	60831-004		FRONT	60831-007	60831-008
	REAR	66435-001	66435-002		REAR	66435-005	66435-007
	FRONT	66435-003	66435-004		FRONT	66435-007	66435-007



TABLE 1

PRIMAAX 230/460/690 • FIREMAAX 240/480						
Vehicle Manufacturer	Drive Axle	*Frame Width	Discontinued Support Beam Assembly Part Number		Cross Tube Part Number	New U-beam Assembly Service Kit Number
			60831-00X • 66435-00X		60912-XXX	60961-XXX
			LEFT HAND	RIGHT HAND		
Volvo • Mack	Forward	33.5"	-003	-004	-005	-237
	Rear		-001	-002		-238
Kenworth • Western Star • All Fire/Rescue (Except Spartan)	Forward	34.0"	-003	-004	-001	-235
	Rear		-001	-002		-236
IPI • Advance • Oshkosh	Forward	34.0" Tall Fab Hanger	-003	-004	-001	-247
	Rear		-001	-002		-248
Freightliner • Sterling • Autocar	Forward	34.3"	-003	-004	-003	-241
	Rear		-001	-002		-242
Freightliner • Sterling	Forward	34.5"	-003	-004	-002	-239
	Rear		-001	-002		-240
International	Forward	34.3"	-003	-004	-003	-261
	Rear		-001	-002		-262
	Forward	34.5"	-003	-004	-002	-263
	Rear		-001	-002		-264
	Forward	34.8"	-003	-004	-009	-243
	Rear		-001	-002		-244
PRIMAAX 260/520/780 • FIREMAAX 270 540						
Kenworth • Western Star • All Fire/Rescue (Except Spartan)	Forward	34.0"	-007	-008	-001	-253
	Rear		-005	-006		-254
Freightliner	Forward	34.3"	-007	-008	-003	-257
	Rear		-005	-006		-258
	Forward	34.5"	-007	-008	-002	-255
	Rear		-005	-006		-256
NOTE: * Contact vehicle manufacturer to verify frame width.						

Refer any questions regarding this publication to Hendrickson Tech Services at 630.910.2800 or email: techservices@hendrickson-intl.com. Visit our website for more information on Hendrickson products, www.hendrickson-intl.com.

www.hendrickson-intl.com



Truck Suspension Systems
800 South Frontage Road
Woodridge, IL 60517-4904 USA

630.910.2800
Fax 630.910.2899