

Click number attached to the part or the part numbers on the next pages to link to other parts, some parts may have no link

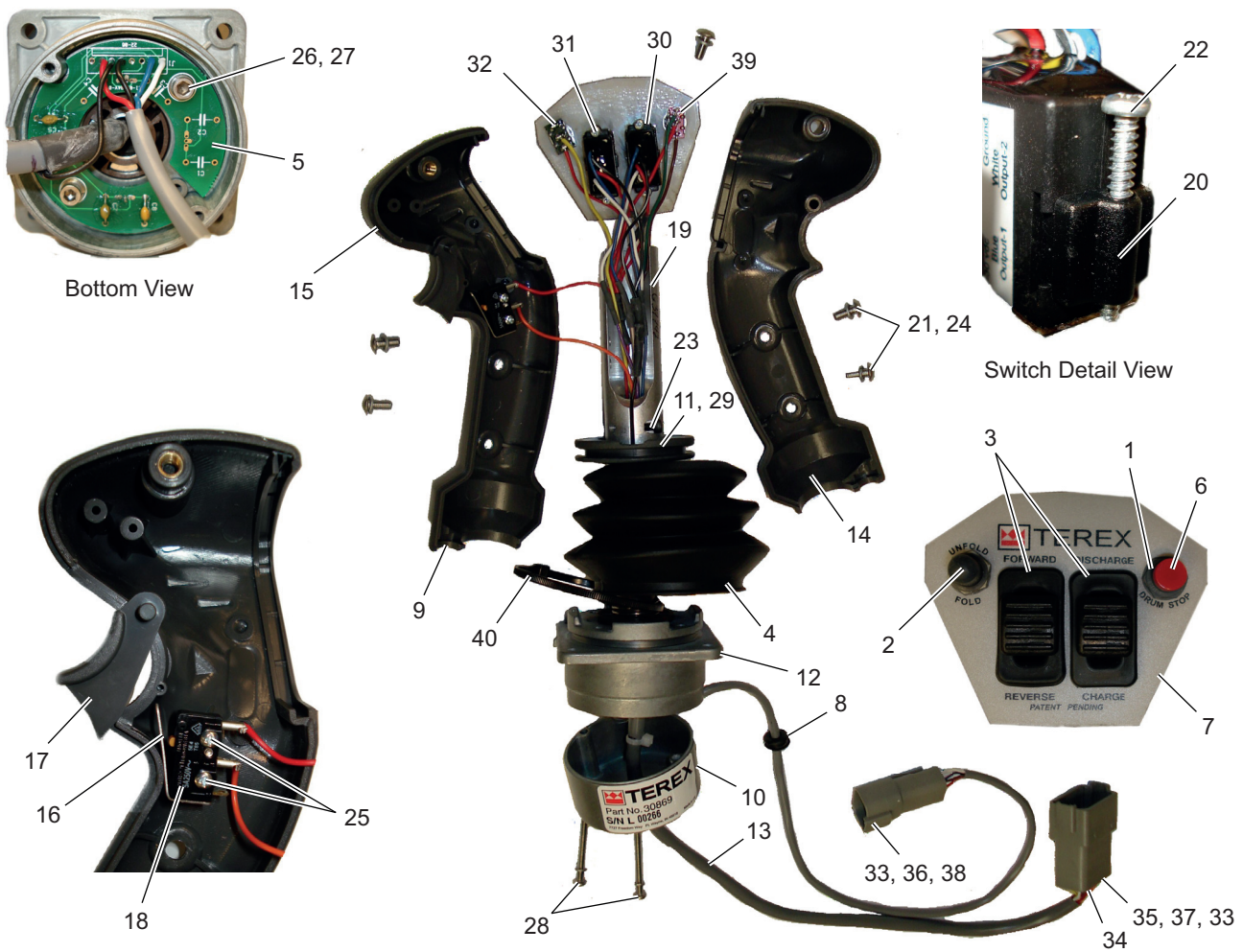

REF	PART NO.	DESCRIPTION	QTY	REF	PART NO.	DESCRIPTION	QTY
1	33811	Toggle Boot: Partial Cover Style-Grey	1	21		10-32 X 7/16" Button Head Socket	
2	33818	Toggle Boot: Full Cover Style-Grey	1	22		SS 18-8.....	5
3	33819	Boot: Slider Module.....	2			#2 X 3/4" Self Tapping	
4		Boot: JM Joystick	1	23		Pan Head Screw	4
5		Joystick Sensor		24		6-32 X 1/2 Cap Screw.....	1
		Circuit Card Assembly.....	1	25		#10 Split Lock Washer	5
6	33810	Red Cap: NKK Switch	1	26		2 X 9/16" Tapping Screw - Pan Head..	2
7		Faceplate Overlay	1			6-32 X 3/8" Socket Cap Screw,	
8		3/8" X 1/4" Grommet	2	27		Stainless.....	2
9		3/8" Hole Plug	1	28		#6 Lock Washer	4
10		Joystick: Housing Cover.....	1			6-32 X 1 3/8" Button Head	
11		Boot Ring For JM Joystick	1	29		Phillips Screw	2
12		JM Joystick: Assembly With		30	33820	Boot Washer For Joystick	1
		CC & Boot	1	31	33821	Slider Module: Switched, Maintained..	1
13		Handle Harness For		32		Slider Module: Switched, Momentary .	1
		L1-E6-01-JM-KF.....	1	33		Standard Switch, 5 AMP	1
14		Handle Case Left, Grey.....	1	34		Deutsch: Crimp Pins	13
15		Handle Case Right, Grey	1	35		Deutsch: Plug Seal	3
16		Leaf Spring For Trigger	1	36		Deutsch: 12 Pin Housing Grey.....	1
17		"L" Single Trigger, Grey	1	37		Deutsch, 4 Pin Housing, Grey.....	1
18	30718	Push Button: Momentary		38		Deutsch: Wedge 12 Pin	1
		Switch Assembly	1	39	33822	Deutsch: Wedge 4 Pin	1
19		Clamping Pin: 12mm Bore Assembly. 1				Toggle: 3 POS MOM,	
20		Retainer: Module Retainer Bracket	4	40		SPDT Assembly.....	1
						4" Tie Wrap	1

WHEN ORDERING PARTS, SPECIFY MODEL NUMBER, SERIAL NUMBER AND DESCRIPTION OF PARTS REQUIRED

	CONTROLS STICK, ELECT/HYD W/TRANS	DATE: Released 01-2016	GROUP 6
		MODEL: FD	
		PAGE: 6.20	